

# RE

Repma Engineering (Pty) Ltd

## Repma M100Q3 Vertical Quad Pack Machine

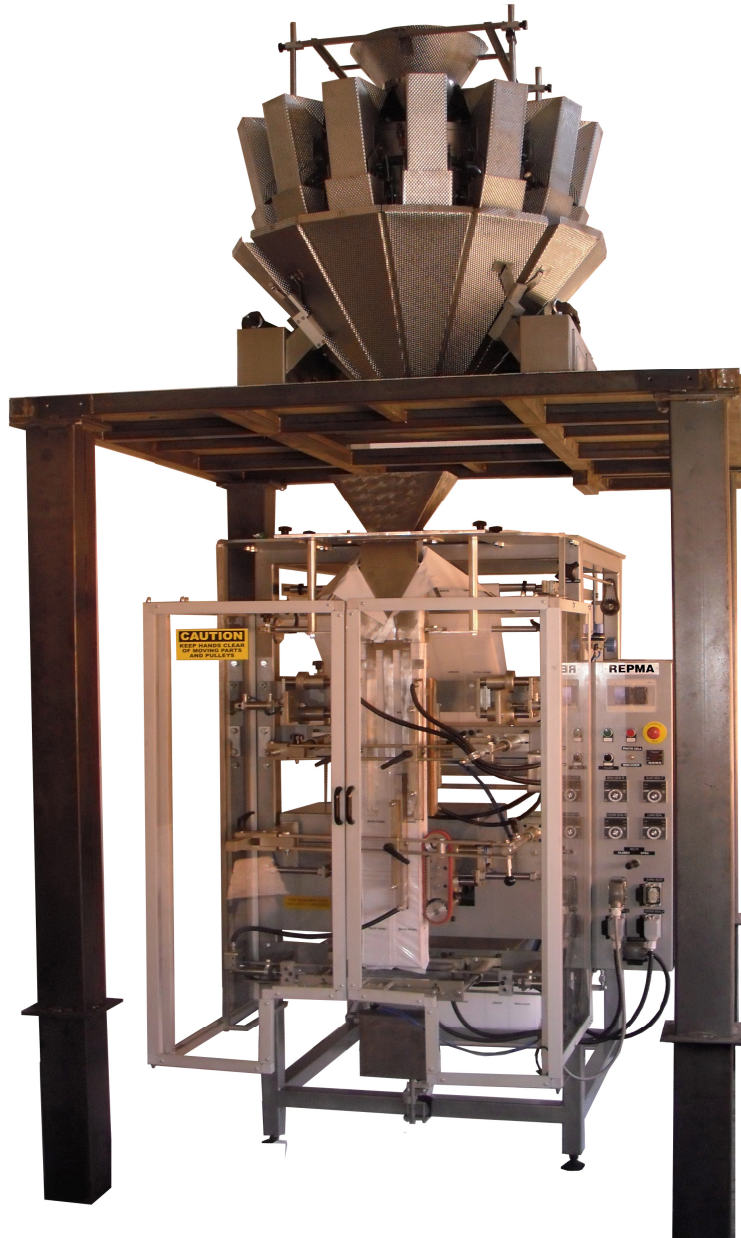

- Fully Automated
- PLC controlled
- Touch Screen operation
- Low maintenance
- All contact parts Stainless Steel

German Technology and Engineering manufactured and designed locally in South Africa

**All REPMA Vertical Machines can be supplied or fitted with the following accessories:**

- Block Bottom Bags Device
  - Gusseted Bags Unit
- Special Seals with Handle or holes for display
  - Photoelectric Cell for Print Registration
    - Dust Collector
  - Anti-Static Electricity Equipment
    - Weight Platform
      - Inert Gas
      - Strip Bags
  - Printer for Code Registration
- Volumetric Cup Filler
  - Auger Filler
- Short, Long Multiple and Specialized weighers
  - Hopper Level Detectors
    - Bucket Elevator
    - Screw Elevator
    - Exit Conveyor
  - Rotary Packing Table
  - Product In-Feed Conveyor
  - Degassing system for Coffee
    - Multi Head Scale

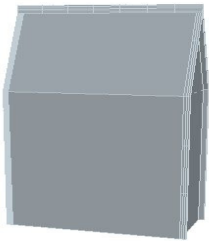

**\* Quad Bag**



**\*\*3 Side Seal**

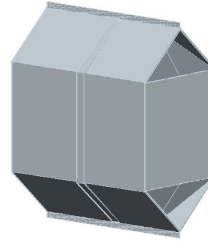

**Side gusset / Pillow bag**

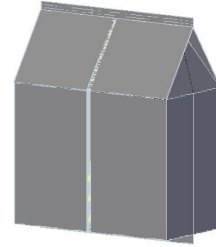

**Block Bottom**

**Technical Data**

| <u>Machine Model</u>           | <u>M80N</u>                                 | <u>M100N</u> | <u>*M100QN<br/>Quad Seal</u> | <u>**M100SS<br/>Side Seal</u> | <u>M125N</u> |
|--------------------------------|---|--------------|------------------------------|-------------------------------|--------------|
| MAX. BAG WIDTH IN MM           | 160   | 260/300      | 260/300                      | 260/300                       | 430          |
| MAX. BAG LENGTH IN MM          | 260   | 410          | 410                          | 410                           | 600          |
| VOLUME IN LITRE                | 1.8   | 10           | 10                           | 10                            | 20           |
| OUTPUT, BAG/MIN, UP TO:        | 100   | 80           | 80                           | 80                            | 25           |
| ELECTRICITY SUPPLY             | 220/380v - 50/60hZ                          |              |                              |                               |              |
| POWER CONSUMPTION, KVA         | 4.5   | 5            | 6                            | 5                             | 6            |
| AIR REQUIREMENTS , 6BAR        | 350L  | 400L         | 400L                         | 400L                          | 600L         |
| FILM MATERIAL                  | ALL HEAD SEALABLE METERIAL AND POLYETHELENE |              |                              |                               |              |
| FILM REEL DIA. MAX. IN MM      | 400   | 600          | 600                          | 600                           | 600          |
| FILM REEL WIDTH MAX. IN MM     | 350   | 630          | 630                          | 630                           | 900          |
| WEIGHT IN KG                   | 440   | 625          | 775                          | 625                           | 650          |
| MACHINE DIMENSION IN MM Width: | 1120  | 1320         | 1940                         | 1320                          | 1480         |
| Depth:                         | 1700  | 2000         | 2000                         | 2000                          | 2000         |
| Height:                        | 1280  | 1700         | 2070                         | 1700                          | 2100         |



**Repma Engineering (Pty) Ltd**

**Repma Engineering (Pty)Ltd**

**Physical Address:**

51c Richard Road  
 Industria North  
 Roodepoort  
 Johannesburg  
 South Africa

**Postal Address:**

Box 420  
 Florida  
 1709

**Tel:** (011) 477 8690

(011) 477 8672

**Fax:** (011) 477 8699

**Web Page:** [www.repmaengineering.com](http://www.repmaengineering.com)

**Email:** [info@repmaengineering.com](mailto:info@repmaengineering.com)

[repmaeng@mweb.co.za](mailto:repmaeng@mweb.co.za)

**Gps coordinates:** 26°10'59.40"S / 27°57'10.89"E